

ARTIST

MOTIVATE

INTEGRITY

LAKE HIGHLANDS / WELCOME TO DAY THREE

INSPIRATION

INCLUSIVENESS

INNOVATION

CREATE

ENGAGED

PROCESS

CREATIVE

TEAM



Please be sure to visit the website for updates.

www.iamlakehighlands.squarespace.com

Password: **wildcats**

Recap from Day Two

Program Elements

Group One

Arts / Fine Arts

Catherine Dalton

Kevin Mereness

Jonathan Greig

Catherine Hamrick

Kelly Moss

Meghann Zenteno

Michele Davis

Vince Venditto

Group Two

Athletics

Le Korte

Kevin Mereness

Ken Kessler

Jesse Bateman

Kyle Hickey

Laura Parker

Mollie Sanders

Wendy Lucas

Group Three

Admin | Clinic | Special Edu

Core Classes | Library | CTE Class.

Vandana Nayak ("V")

Kevin Mereness

Sandra Hayes

Alyssa Ramsey

Barbara Hahn

Blanca Webb

Carrie Breedlove

Celiese Delasbour

Condy Salling

Darwin Spiller

Denise Enriquez

Erin Anderson

Jeanette Reese

Kellie Weimer

Melanie Theissen

Melissa Massey

Sarah Pankonien

Sydney Westbay

Critical Adjacencies



Adjacency Plan Diagram

Your 3 most important points are...
1. _____
2. _____
3. _____



gym & athletics side where ball court will be

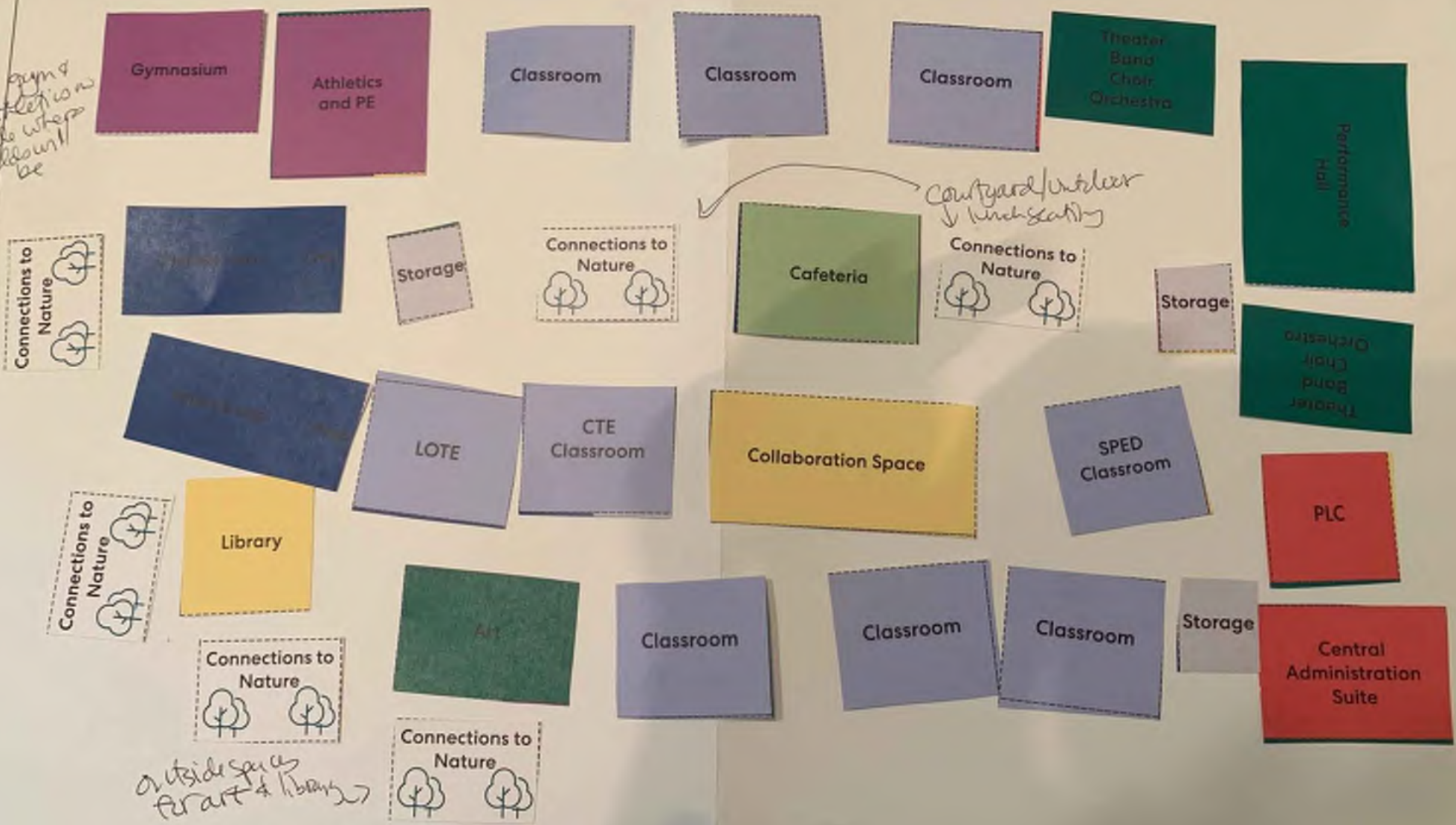

Adjacency Plan Diagram

- Your 3 most important points are...
1. Organized and easy access to important areas
 2. Big spaces for collaboration
 3. Natural light in most areas

Webb
 Arrange your spaces on this page



Adjacency Plan Diagram

Your 3 most important points are...

1. Office space
2. LIB & Collaboration
3. performance hall

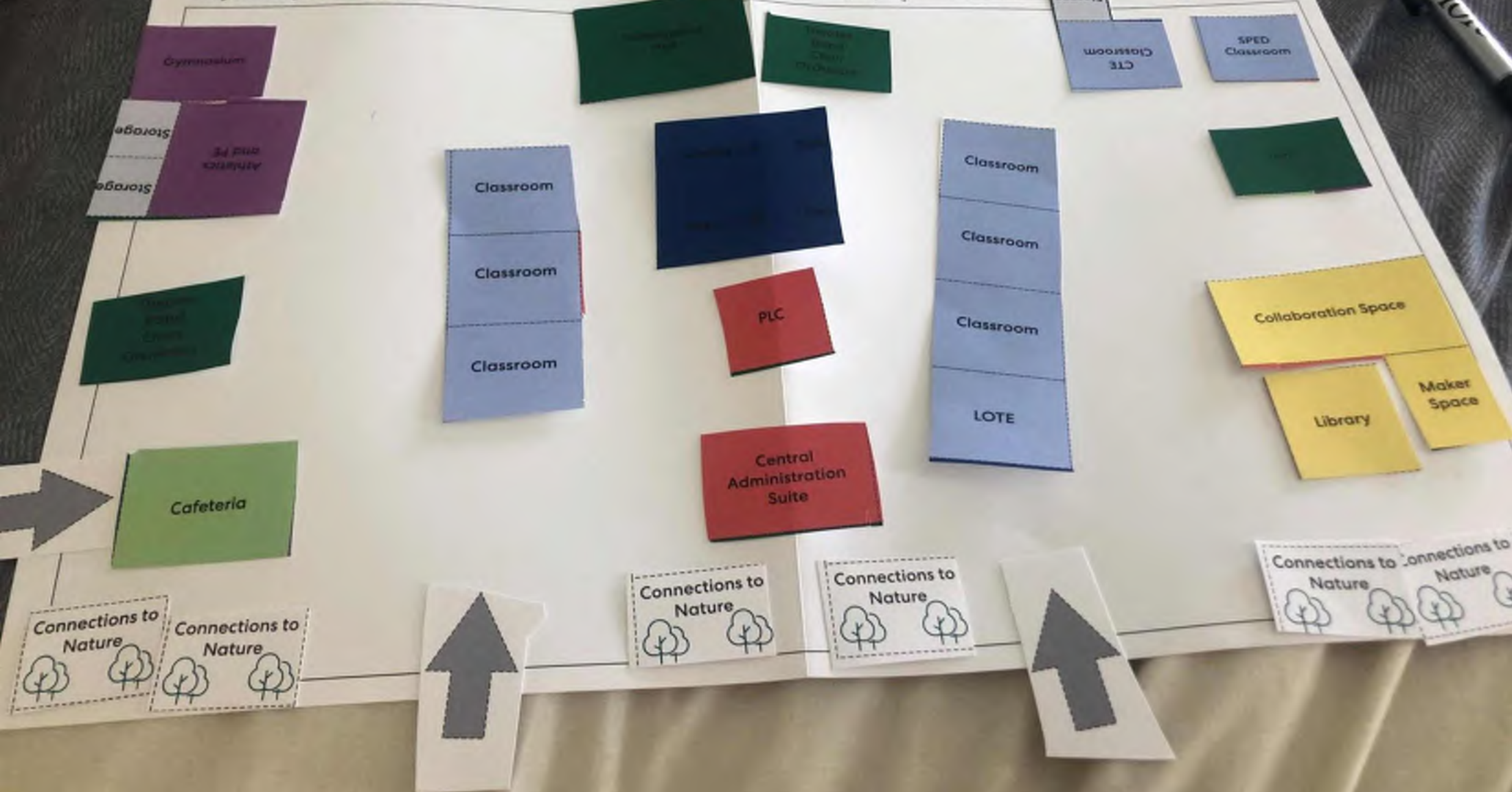

Adjacency Plan Diagram

Your 3 most important points are...

- *Connections to Nature placement*
- 1. Prep room / CTE close to Nurse
- 2. Display cases needed
- 3. Display cases needed



Adjacency Plan Diagram

Library to get a relatively smaller space

Management for Library a Cafe!

- 1. All Library space to be used. To have off
- 2. Library should be in a central location and easy to get to from all sides



Perkins&Will

Adjacency Diagram

Your 3 most important points are...

1. Safety for everyone
2. Keep grade levels separate
3. Function over form



- PLC - should be quiet workspace
- Content storage

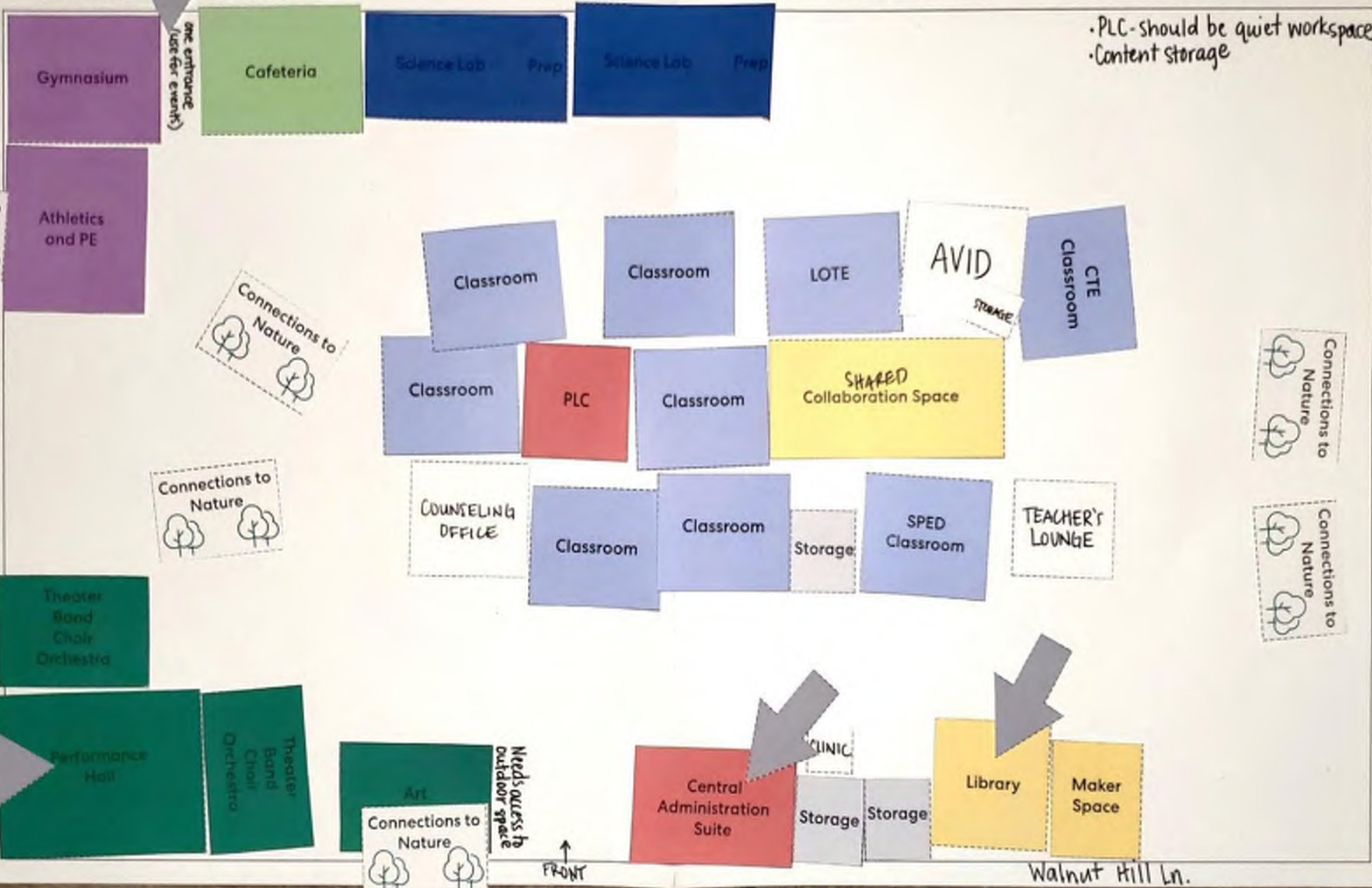

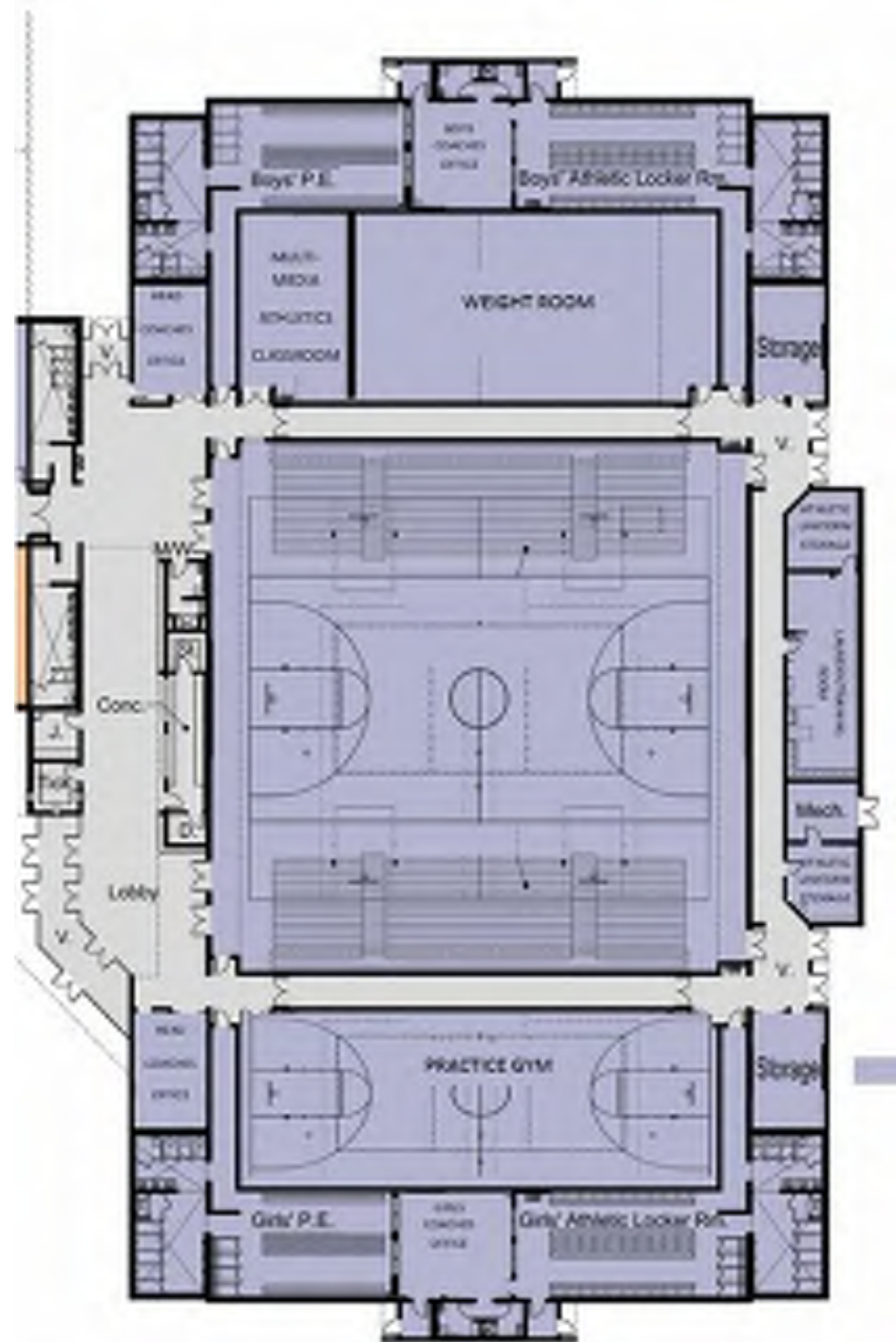

Adjacency Plan Diagram

Connections to Nature

Your 3 most important points are...

1. WINDOWS - Natural light!
2. Electives in Wings together (less distracting)
3. Clear overall scheme in direction and grouping of areas.

Arrange your space on this page

Nature

outside access

outside access

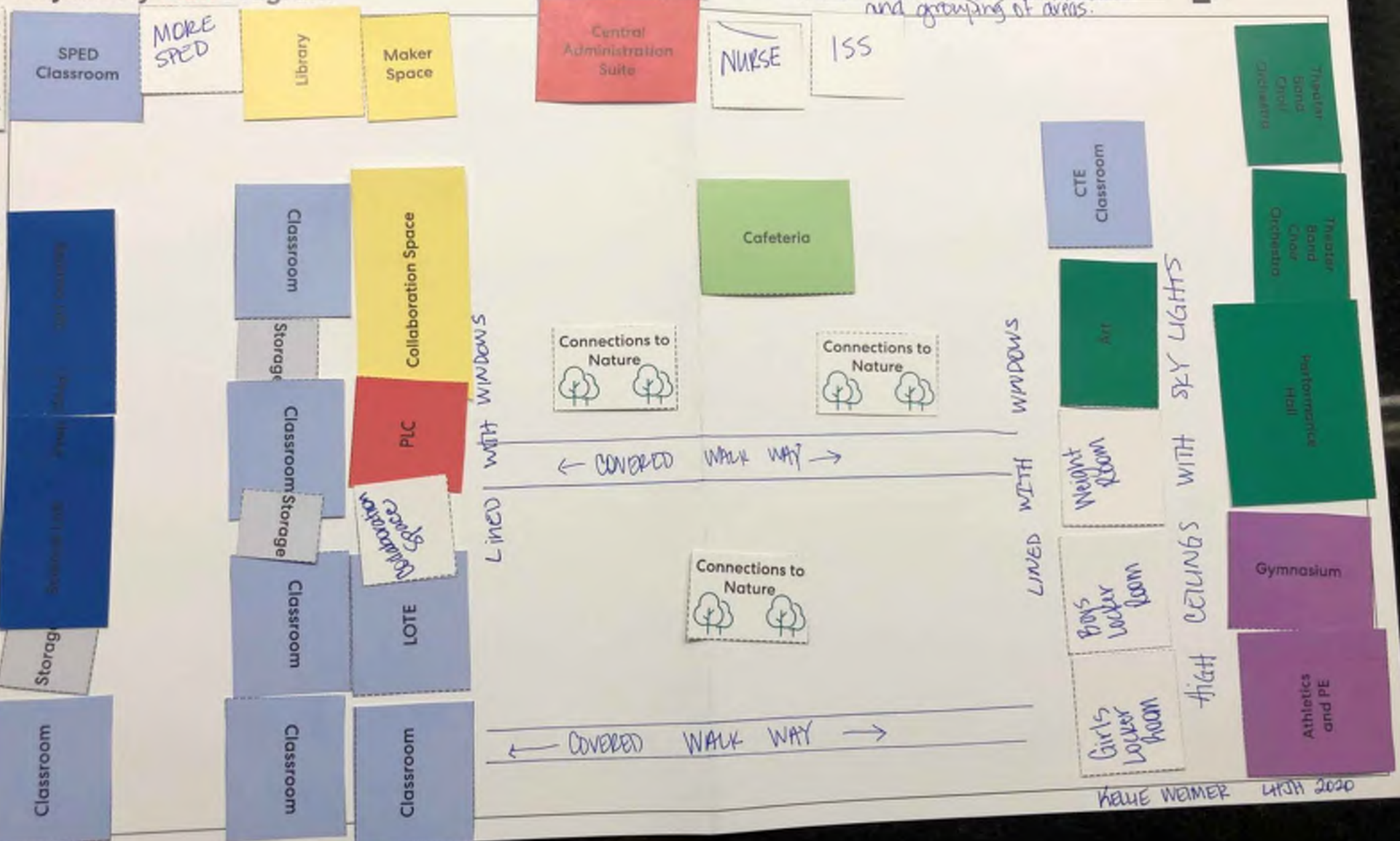

KARLE WEIMER 4/13/2020

Adjacency Plan Diagram

- Your 3 most important points are...
1. Should 4th grade move up - they should be separate from 7/8
 2. Visual/Performing arts should be together
 3. PLC away from central office, but near classroom

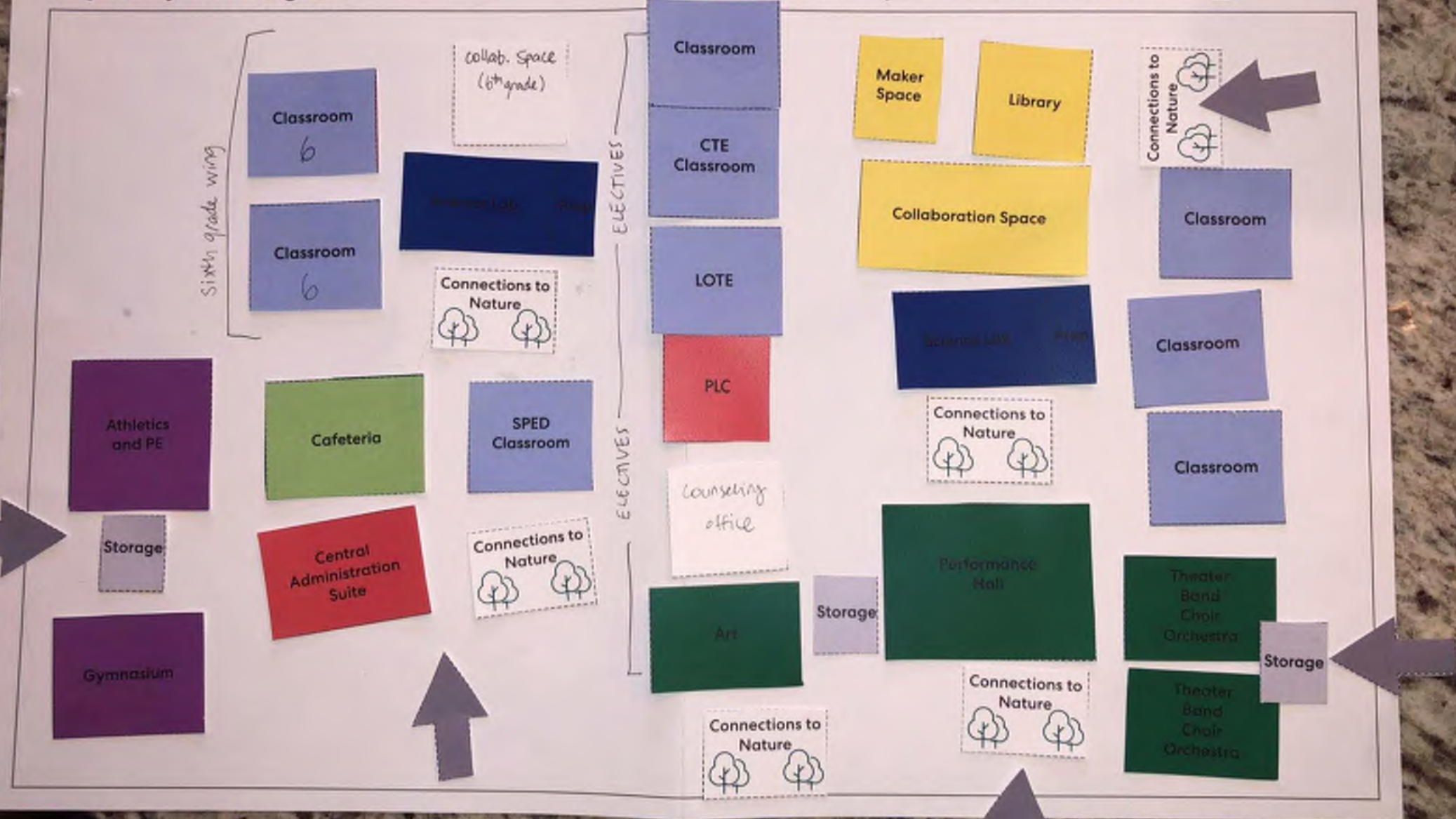

Adjacency Program

- Your 3 most important points are...
1. Emphasis on Nature
 2. Library & Admin in center
 3. collaboration amongst contents + shared spaces

Arrange your spaces on this page



Adjacency Plan Diagram

Check OHS
classroom layout
for wall thickness?



It could be ideal to keep Science Lab and CTE Classrooms together and provide additional Green Room to Nature

- Your 3 most important points are:
1. Connecting and flow (ward areas in block) around central
 2. Plan for a variety of connections to nature
 3. High addressability (visibility) from what is the view from the Hall



Main Entrance

Library and Cafe/Bar surrounded by connections to nature

Gym Performance Hall through some type of connection to nature

Next Meeting Thursday, June 18th

- Planning Diagram Options

Please be sure to visit the website for updates:

www.iamlakehighlands.squarespace.com

Password: wildcats



ARTIST

MOTIVATE

INTEGRITY

INSPIRATION

LAKE HIGHLANDS

INCLUSIVENESS

INNOVATION

CREATE

ENGAGED

PROCESS

CREATIVE

TEAM

APPROACH

/ THANK YOU